

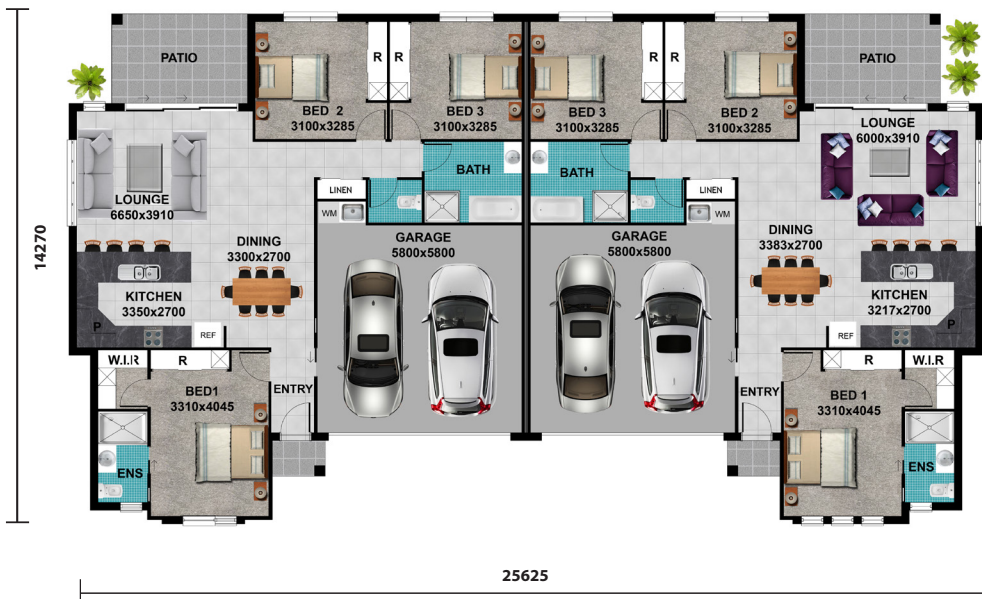

'The Ashwood'



Floor Plan



-  6 BED
-  4 LIVING
-  4 BATH
-  4 GARAGE
-  ALFRESCO

Floor Area

- Unit 1 - 161.12 m²
- Unit 2 - 161.26 m²
- Each Alfresco Area - 9.52 m²
- Each Porch Area - 1.48 m²
- Total Floor Area - 322.38 m²



For more information

admin@mkcgroup.com.au
 0746 932 497
 P.O. Box 445
 Pittsworth Qld 4356
 A.B.N. 84147894068

This artist impression and floor illustration represented in this brochure is for advertising purposes only. This brochure does not form part of any contract and should be used as a guide only.